



FACULTY ART DESIGN AND ARCHITECTURE

2014 November

Main Assessment

DEPARTMENT OF ARCHITECTURE

<u>MODULE NAME</u>	:	Housing IV
<u>MODULE CODE</u>	:	BHS 41-1
<u>DATE</u>	:	11 November 2014
<u>DURATION</u>	:	180
<u>TIME</u>	:	12:30
<u>TOTAL MARKS</u>	:	100

<u>ASSESSOR(S)</u>	:	H.M. Dodd
<u>MODERATOR(S)</u>	:	Dr S. Charlton
<u>NUMBER OF PAGES:</u>	:	3

INSTRUCTIONS TO CANDIDATES:

- Question papers must be handed in.
- This is an open book assessment.
- Read the questions carefully and answer only what is asked.
- Answer all questions
- Number your answers clearly.
- Write neatly and legibly.
- Structure your answers by using appropriate headings and sub-headings.
- The general University of Johannesburg policies, procedures and rules pertaining to written assessments apply to this assessment.

QUESTION 1

- (a) Discuss the concept of a 'housing ladder' in relation to housing supply and demand (5)
- (b) Housing can be seen as an 'asset'. Describe what this means in terms of the investment of the state in a housing delivery programme and the role of the housing market. (10)
- (c) The Peruvian economist, Hernando de Soto describes the concept of "dead capital" Describe the implications of this concept in relation to the housing market. (10)
- [25]
-

QUESTION 2

- (a) Define the concept of DENSITY. Discuss its impact on urban life, ecology, form, infrastructure and services. Discuss both positive and negative impacts. (10)
- (b) Using a specific example of a housing type, discuss its impact in terms of urban morphology and urban footprint. (10)
- [20]
-

QUESTION 3

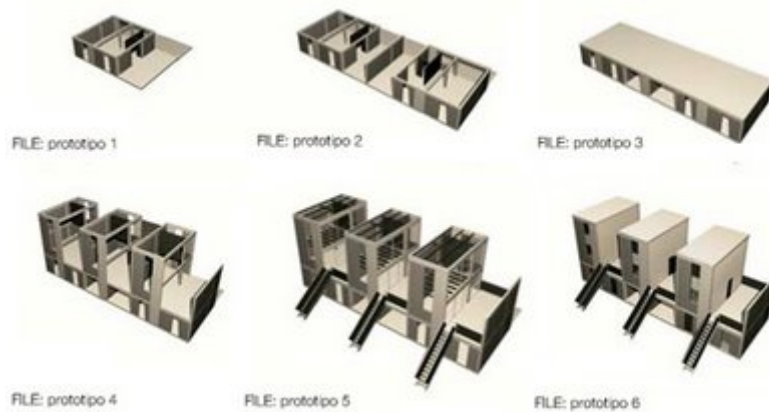

In relation to the work of *Alejandro Aravena and Elemental in Chile*, how are the theories of one of the following – John Habraken (Supports), Nabeel Hamdi (Supporter vs provider paradigm) or John Turner (Housing as a verb) integrated into this example ?

(20)

[20]

[100]